

Rhombic-flanged type

UCFL
Cylindrical bore (with set screws)
 d 12 ~ (45) mm

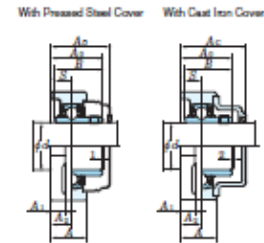
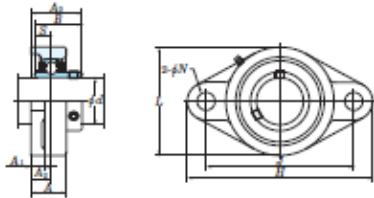

Variations of tolerance of distance from mounting surface to center of spherical bore (A_{10}) and tolerance of position of bolt hole (X)
Unit: mm

Housing No.	A_{10}	X
FL204-R-218	R-205-R-210	R-205-F1-201
FL201-R-218	R-205-R-210	R-205-F1-201

Variations of tolerance of bolt hole diameter (A_6)
Unit: mm

Housing No.	A_6
FL204-R-218	R-205-F1-201
FL201-R-218	R-205-F1-201

Form and dimensions of L₁ of UCFL205 and UCFL206 bearings with cast iron cover as shown below.

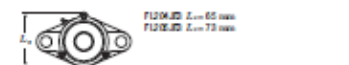

Shaft Dia. mm inch	Dimensions inch mm											Bolt Size inch mm	Unit No.	Standard Housing No.	Bearing No.	Mass kg	Basic Load Ratings			Factor f_0	With Pressed Steel Cover				With Cast Iron Cover														
	H	L	A	J	N	A_1	A_2	A_3	B	S	C						C_0	C_{00}	Open End Type		Closed End Type	Dimension mm inch	Mass kg	Open End Type	Closed End Type	Dimension mm inch	Mass kg												
12													UCFL201 UCFL201-8		UC201 UC201-8	0.90 0.90				UCFL201C	UCFL201D	37.5	1 1/2	0.90															
15													UCFL202 UCFL202-10	FL204	UC202 UC202-10	0.48 0.48	12.8	6.65	0.302	13.2	UCFL202C	UCFL202D	37.5	1 1/2	0.48														
17													UCFL203 UCFL204-12		UC203 UC204-12	0.47 0.47					UCFL203C	UCFL203D	37.5	1 1/2	0.47														
20													UCFL204 UCFL205-14		UC204 UC205-14	0.46 0.64					UCFL204C	UCFL204D	37.5	1 1/2	0.46	UCFL204FC	UCFL204FD	46	1 3/4	0.6									
25													UCFL205 UCFL205-15	FL206	UC205 UC205-15	0.64 0.64	14.0	7.85	0.357	13.9	UCFL205C	UCFL205D	40.5	1 3/4	0.64	UCFL205FC	UCFL205FD	49	1 7/8	0.83									
													UCFL206 UCFL206-16	FL305	UC206 UC206-16	0.64 0.64					UCFL206C	UCFL206D	44.5	1 3/4	1.1														
													UCFL305 UCFL305-16	FL305	UC305 UC305-16	1.1 1.1	21.2	10.9	0.495	12.6						UCFL305C	UCFL305D	54	2 1/8	1.4									
													UCFL206-18 UCFL206 UCFL206-19	FL206	UC206-18 UC206 UC206-19	0.98 0.98 0.98	19.5	11.3	0.514	13.9	UCFL206C	UCFL206D	44.5	1 3/4	0.98	UCFL206FC	UCFL206FD	53	2 1/8	1.2									
													UCFL206-19 UCFL206-20	FL306	UC306 UC306-19	1.5 1.5	25.7	15.4	0.700	13.9	UCFL206C	UCFL206D	49	1 7/8	1.5														
													UCFL306 UCFL306-20	FL306	UC306 UC306-20	1.5 1.5	26.7	15.0	0.682	13.3						UCFL306C	UCFL306D	59	2 3/8	1.8									
													UCFL207-20 UCFL207-21		UC207-20 UC207-21	1.2 1.2																							
													UCFL207-22 UCFL207	FL207	UC207-22 UC207	1.2 1.2	26.7	15.4	0.700	13.9	UCFL207C	UCFL207D	49	1 7/8	1.2	UCFL207FC	UCFL207FD	58	2 1/8	1.6									
													UCFL207-23 UCFLX07-22		UC207-23 UCX07-22	1.2 1.9																							
													UCFLX07 UCFLX07-23	FLX07	UCX07 UCX07-23	1.9 1.9	29.1	17.8	0.809	14.0	UCFLX07C	UCFLX07D	55.5	2 1/8	1.9														
													UCFL307 UCFL307-24	FL307	UC307 UC307-24	1.8 1.6	33.4	19.3	0.877	13.2						UCFL307C	UCFL307D	64	2 5/8	2.2									
													UCFL208-24 UCFL208-25	FL208	UC208-24 UC208-25	1.6 1.6	29.1	17.8	0.809	14.0	UCFL208C	UCFL208D	55.5	2 1/8	1.6	UCFL208FC	UCFL208FD	64	2 5/8	2.0									
													UCFL208 UCFLX08-24		UC208 UCX08-24	1.6 2.1																							
													UCFLX08 UCFL308-24	FL308	UCX08-24 UC308	2.1 2.5	34.1	21.3	0.968	14.0	UCFLX08C	UCFLX08D	56.5	2 1/8	2.1														
													UCFL308 UCFL209-26		UC308 UC209-26	2.5 1.9												UCFL308C	UCFL308D	71	2 7/8	3.0							
													UCFL209-27 UCFL209-28	FL209	UC209-27 UC209-28	1.9 1.9	34.1	21.3	0.968	14.0																			
													UCFL209 UCFLX09-28		UC209 UCX09-28	1.9 2.4																							
													UCFLX09 UCFLX09	FLX09	UCX09 UCX09	2.4 2.4	35.1	23.3	1.06	14.4	UCFLX09C	UCFLX09D	60	2 3/8	2.4														

Remarks 1. In Part No. of unit and units with covers, fitting codes follow bore diameter numbers. (See Table 2.5 in P.11.)
 2. Part No. of applicable grease nipples are shown below.
 A-14-29UNF 207-210, X05-X09, 305-308
 A-R16 211-218, X10, 309-324
 3. As for the triple-lip seal type product (from 201 to 205 are the double-lip seal type products), supplementary code L3 (or L2) follows the Part No. of unit or bearing. (Example of Part No.: UCFL206/L3, UC206/L3)
 4. For the dimensions and forms of applicable bearings, see the dimensional tables of ball bearing for unit.
 5. Housings of spheroidal graphite iron casting are also available.

Rhombic-flanged type

UCFL
Cylindrical bore (with set screws)
d (45) ~ (90) mm

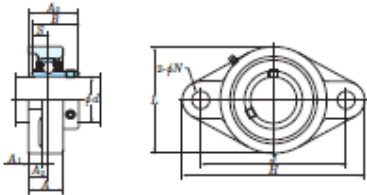

With Pressed Steel Cover With Cast Iron Cover

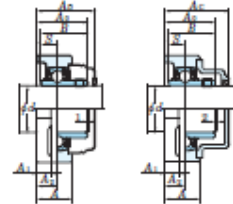

Variations of tolerance of distance from mounting surface to center of spherical bore (L_{10}) and tolerance of position of ball hole (X)

Unit: mm			
Housing No.	L_{10}	X	
FL304-FL310, FL305-FL311, FL305-FL310	± 0.05	± 0.1	
FL311-FL316	± 0.1	± 0.2	

Variations of tolerance of ball hole diameter (d_h)

Unit: mm		
Housing No.	d_h	
FL304-FL310, FL305-FL311	± 0.02	
FL311-FL316	± 0.03	

Form and dimensions of L_{10} of FL304 and FL305 (bearing with carbon cover) are shown below.



Shaft Dia. mm inch	d	Dimensions inch mm										Bolt Size inch mm	Standard Housing No.		Bearing No.	Mass kg	Basic Load Ratings kN		Fatigue Load Limit kN	Factor f_0	With Pressed Steel Cover			With Cast Iron Cover								
		H	L	A	J	N	A ₁	A ₂	A ₃	B	S		Unit No.	Housing No.			Open End Type	Closed End Type			Dimension mm inch	Mass kg	Open End Type	Closed End Type	Dimension mm inch	Mass kg						
45	1 1/4	9 1/8	4 3/8	1 3/8	6 1/8	1 1/8	1 1/8	1 1/8	2 1/8	2.244	0.866	1/2	UCFL300-28	FL309	UC309-28	3.5	48.9	29.5	1.34	13.3	-	-	-	-	-	-	-	-	-	-	-	-
	1 1/8	230	125	44	177	25	18	25	60	57	22	M22	UCFL300		UC309	3.5																
50	1 3/4	7 3/4	4 1/8	1 3/8	6 1/8	1 1/8	1 1/8	1 1/8	2 1/8	2.031	0.748	1/2	UCFL210-30	FL210	UC210-30	2.2																
	1 3/8	197	115	40	157	19	15	22	54.6	51.6	19	M16	UCFL210-31		UC210-31	2.2																
	2												UCFL210		UC210	2.2	35.1	23.3	1.06	14.4	UCFL210C	UCFL210D	59	2 1/8	2.2	UCFL210FC	UCFL210FD	70.5	2 3/8	2.7		
	1 3/4												UCFL210-32		UC210-32	2.2																
50	1 3/4	8 1/4	5 1/4	1 3/8	7 1/4	1 1/8	1 1/8	1 1/8	2 1/8	2.189	0.824	1/2	UCFLX10-31	FLX10	UCX10-31	3.8																
	2	216	133	44	184	19	20	26	58.4	55.6	22.2	M16	UCFLX10		UCX10	3.8	43.4	29.4	1.34	14.4	UCFLX10C	UCFLX10D	64	2 1/2	3.8	UCFLX10FC	UCFLX10FD					
55	2 1/4	9 1/8	5 1/8	1 3/8	7 1/8	1 1/8	1 1/8	1 1/8	2 1/8	2.402	0.866	1/2	UCFL310	FL310	UC310	4.4	62.0	38.3	1.74	13.2	-	-	-	-	-	-	-	-	-	-	-	-
	2	240	140	48	187	25	19	28	67	61	22	M22	UCFL310		UC310	4.4																
55	2 1/4	8 1/4	5 1/4	1 1/8	7 1/4	1 1/8	1 1/8	1 1/8	2 1/8	2.189	0.824	1/2	UCFL211-32	FL211	UC211-32	3.3																
	2 1/8	224	130	43	184	19	18	25	58.4	55.6	22.2	M16	UCFL211-34		UC211-34	3.3	43.4	29.4	1.34	14.4	UCFL211C	UCFL211D	63	2 1/8	3.3	UCFL211FC	UCFL211FD	74.5	2 1/4	3.9		
	2 3/4												UCFL211		UC211	3.3																
	2	9 1/8	5 3/8	2 1/8	7 1/8	1 1/8	1 1/8	1 1/8	2 1/8	2.288	0.864	1/2	UCFL311-32	FL311	UC311-32	5.3	71.6	45.0	2.05	13.2	-	-	-	-	-	-	-	-	-	-	-	-
60	2 1/4	9 1/8	5 1/8	1 3/8	7 1/8	1 1/8	1 1/8	1 1/8	2 1/8	2.263	1.000	1/2	UCFL212-36	FL212	UC212-36	4.2																
	2 3/4	250	140	48	202	23	18	29	68.7	65.1	25.4	M20	UCFL212		UC212	4.2	52.4	36.2	1.65	14.4	UCFL212C	UCFL212D	73.5	2 3/8	4.2	UCFL212FC	UCFL212FD	86	3 1/4	5.0		
	2 1/2												UCFL212-38		UC212-38	4.2																
	2 3/4												UCFL212-39		UC212-39	4.2																
65	2 1/2	10 1/4	6 1/4	2 1/8	8 1/4	1 1/8	1 1/8	1 1/8	3 1/8	2.795	1.034	1	UCFL312	FL312	UC312	6.5	81.9	52.2	2.37	13.2	-	-	-	-	-	-	-	-	-	-	-	
	2 3/4	270	160	56	212	31	22	33	78	71	26	M27	UCFL213-40	FL213	UC213-40	5.1	57.2	40.1	1.82	14.4	UCFL213C	UCFL213D	74.5	2 3/8	5.1	UCFL213FC	UCFL213FD	87	3 1/8	5.9		
65	2 1/2	11 1/4	6 1/4	2 1/8	9 1/4	1 1/8	1 1/8	1 1/8	3 1/8	2.953	1.131	1	UCFL313-40	FL313	UC313-40	8.5																
	2 3/4	295	175	58	240	31	25	33	78	75	30	M27	UCFL313		UC313	8.5	92.7	59.9	2.68	13.2	-	-	-	-	-	-	-	-	-	-	-	
70	2 3/4	10 1/4	6 1/4	2 1/8	8 1/4	1 1/8	1 1/8	1 1/8	2 1/8	2.907	1.189	1/2	UCFL214-44	FL214	UC214-44	5.7																
	2 3/4	265	160	54	216	23	20	31	75.4	74.6	30.2	M20	UCFL214		UC214	5.7	62.2	44.1	2.01	14.5	UCFL214C	UCFL214D	80.5	3 1/8	5.7	UCFL214FC	UCFL214FD	93	3 3/8	6.6		
75	2 3/4	12 1/4	7 1/4	2 1/8	9 1/4	1 1/8	1 1/8	1 1/8	3 1/8	3.071	1.259	1 1/2	UCFL314-44	FL314	UC314-44	9.7																
	2 3/4	315	185	61	250	35	28	36	81	78	33	M30	UCFL314		UC314	9.7	104	68.2	2.96	13.2	-	-	-	-	-	-	-	-	-	-		
	2 3/4												UCFL215-47		UC215-47	6.4																
	2 3/4												UCFL215		UC215	6.4	67.4	48.3	2.17	14.5	UCFL215C	UCFL215D	83.5	3 1/8	6.4	UCFL215FC	UCFL215FD	96	3 3/8	7.4		
75	3	12 1/4	7 1/4	2 1/8	10 1/4	1 1/8	1 1/8	1 1/8	3 1/8	3.228	1.260	1 1/2	UCFL315-47	FL315	UC315-47	11.3																
	3	320	195	66	260	35	30	39	89	82	32	M30	UCFL315		UC315	11.3	113	77.2	3.24	13.2	-	-	-	-	-	-	-	-	-	-		
80	3 1/4	11 1/4	7 1/4	2 1/8	9 1/4	1 1/8	1 1/8	1 1/8	3 1/8	3.252	1.311	1 1/2	UCFL216-50	FL216	UC216-50	7.8																
	3 1/4	290	180	58	233	25	20	34	83.3	82.6	33.3	M22	UCFL216		UC216	7.8	72.7	53.0	2.30	14.6	UCFL216C	UCFL216D	88.5	3 1/8	7.8	UCFL216FC	UCFL216FD	103	4 1/8	9.0		
85	3 1/2	13 1/4	8 1/4	2 1/8	11 1/4	1 1/8	1 1/8	1 1/8	3 1/8	3.386	1.339	1 1/2	UCFL316	FL316	UC316	14.4	123	86.7	3.53	13.3	-	-	-	-	-	-	-	-	-	-		
	3 1/2	355	210	68	285	38	32	38	90	86	34	M33	UCFL316		UC316	14.4																
85	3 1/2	12 1/4	7 1/4	2 1/8	9 1/4	1 1/8	1 1/8	1 1/8	3 1/8	3.374	1.343	1 1/2	UCFL217-52	FL217	UC217-52	9.8																
	3 1/2	305	190	63	248	25	22	36	87.6	86.7	34.1	M22	UCFL217		UC217	9.8	84.0	61.9	2.60	14.5	UCFL217C	UCFL217D	92.5	3 3/8	9.8	UCFL217FC	UCFL217FD	107	4 1/8	11.2		
90	3 3/4	14 1/4	8 1/4	2 1/8	11 1/4	1 1/8	1 1/8	1 1/8	3 1/8	3.700	1.575	1 1/2	UCFL317	FL317	UC317	16.0	133	96.8	3.82	13.3	-	-	-	-	-	-	-	-	-	-		
	3 3/4	370	220	74	300	38	32	44	100	96	40	M33	UCFL317		UC317	16.0																
90	3 1/2	12 1/4	8 1/4	2 1/8	10 1/4	1 1/8	1 1/8	1 1/8	3 1/8	3.270	1.363	1 1/2	UCFL218-56	FL218	UC218-56	12.3																
	3 1/2	320	205	68	265	25	23	40	96.3	96	39.7	M22	UCFL218		UC218	12.3	96.1	71.5	2.91	14.5	UCFL218C	UCFL218D	101.5	4	12.3	UCFL218FC	UCFL218FD	116	4 1/8	13.8		

Remarks 1. In Part No. of unit and units with covers, fitting codes follow bore diameter numbers. (See Table 2.5 in P.11.)
2. Part No. of applicable grease nipples are shown below.
A-1/4-28UNF.....201-210, X05-X09, 305-308
A-R1/8.....211-218, X10, 300-324

3. As for the triple-lip seal type product (from 201 to 205 are the double-lip seal type products), supplementary code L3 (or L2) follows the Part No. of unit or bearing. (Example of Part No.: UCFL206L3, UC206L3)
4. For the dimensions and forms of applicable bearings, see the dimensional tables of ball bearing for unit.
5. Housings of spheroidal graphite iron casting are also available.

Rhombic-flanged type

UCFL
Cylindrical bore (with set screws)
d (90) ~ 120 mm

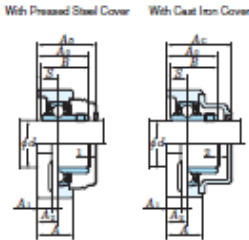
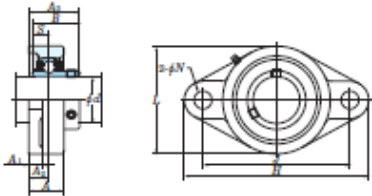

Variations of tolerance of distance from mounting surface to center of spherical bore [*d_{1a}*] and tolerance of position of both hole [*R*]. Unit: mm

Housing No.	<i>d_{1a}</i>	<i>R</i>
FL304-R-210, R-305-R-210, R-305-R-230	±0.05	0.7
FL319-R-210	±0.05	1

Variations of tolerance of both hole diameter [*d_{2a}*]. Unit: mm

Housing No.	<i>d_{2a}</i>
FL304-R-210, R-305-R-210, R-305-FL311	±0.02
FL319-R-210	±0.03

Form and dimensions of *L₁* of FL204-FL205 or FL305-FL306 (bearing with cast iron cover) are shown below.

FL204, FL205 *L₁* = 65 mm
FL305, FL306 *L₁* = 73 mm

Shaft Dia. mm	inch	Dimensions										Bolt Size inch	Unit No.	Standard Housing No.	Bearing No.	Mass kg	Basic Load Ratings			Factor <i>f₀</i>	With Pressed Steel Cover		Dimension mm	inch	Mass kg	With Cast Iron Cover		Dimension mm	inch	Mass kg	
		<i>H</i>	<i>L</i>	<i>A</i>	<i>J</i>	<i>N</i>	<i>A₁</i>	<i>A₂</i>	<i>A₃</i>	<i>B</i>	<i>S</i>						<i>C₀</i>	<i>C₁₀</i>	<i>C₀</i>		Open End Type	Closed End Type				Open End Type	Closed End Type				
90	3 1/2	15 1/2	9 1/4	3	12 3/32	1 1/2	1 1/2	1 4/16	3 3/16	3.750	1.575	1 1/4	UCFL318-56	FL318	UC318-56	19.0	143	107	4.11	13.3	-	-	-	-	-	-	-	-	-	-	-
		385	235	75	315	38	36	44	100	96	40	M33	UCFL318	FL318	UC318	19.0	143	107	4.11	13.3	-	-	-	-	-	-	UCFL318C	UCFL318D	119	4 11/16	20.9
95	-	15 9/16	9 11/16	3 11/16	13	1 5/8	1 5/8	2 1/8	4 1/4	4.055	1.614	1 1/2	UCFL319	FL319	UC319	24.6	153	119	4.45	13.3	-	-	-	-	-	-	-	-	-	-	-
		405	250	94	330	41	40	59	121	103	41	M36	UCFL319	FL319	UC319	24.6	153	119	4.45	13.3	-	-	-	-	-	-	UCFL319C	UCFL319D	140	5 1/2	26.8
100	3 9/16	17 1/8	10 1/8	3 1/8	14 1/8	1 5/8	1 5/8	2 1/4	4 3/8	4.252	1.654	1 1/2	UCFL320	FL320	UC320	29.4	179	141	5.08	13.2	-	-	-	-	-	-	-	-	-	-	-
		440	270	94	360	44	40	59	125	108	42	M39	UCFL320-63	FL320	UC320-63	29.4	179	141	5.08	13.2	-	-	-	-	-	-	UCFL320C	UCFL320D	146	5 7/8	32.2
110	-	18 1/2	11 1/8	3 3/8	15 3/8	1 7/8	1 7/8	2 3/4	5 1/4	4.606	1.811	1 1/2	UCFL322	FL322	UC322	36.2	206	180	6.15	13.2	-	-	-	-	-	-	-	-	-	-	-
		470	300	96	390	44	42	60	131	117	46	M39	UCFL322	FL322	UC322	36.2	206	180	6.15	13.2	-	-	-	-	-	-	UCFL322C	UCFL322D	154	6 1/8	39.6
120	-	20 1/2	13	4 1/2	16 3/4	1 7/8	1 7/8	2 3/4	5 7/8	4.951	2.008	1 1/2	UCFL324	FL324	UC324	51.6	207	185	6.10	13.5	-	-	-	-	-	-	-	-	-	-	-
		520	330	110	430	47	48	66	140	126	51	M42	UCFL324	FL324	UC324	51.6	207	185	6.10	13.5	-	-	-	-	-	-	UCFL324C	UCFL324D	163	6 3/8	56.4

Remarks 1. In Part No. of unit and units with covers, fitting codes follow bore diameter numbers. (See Table 2.5 in P.11.)
 2. Part No. of applicable grease nipples are shown below.
 A-14-28UNF.....201-210, X05-X09, 305-308
 A-R1/8.....211-218, X10, 309-324
 3. As for the triple-lip seal type product (from 201 to 205 are the double-lip seal type products), supplementary code LS (or L2) follows the Part No. of unit or bearing. (Example of Part No.: UCFL206.LS, UC206LS)
 4. For the dimensions and forms of applicable bearings, see the dimensional tables of ball bearing for unit.
 5. Housings of spheroidal graphite iron casting are also available.